

**10TH, 22ND FLOOR PLAN
(REFUGE - UPPER DUPLEX)**

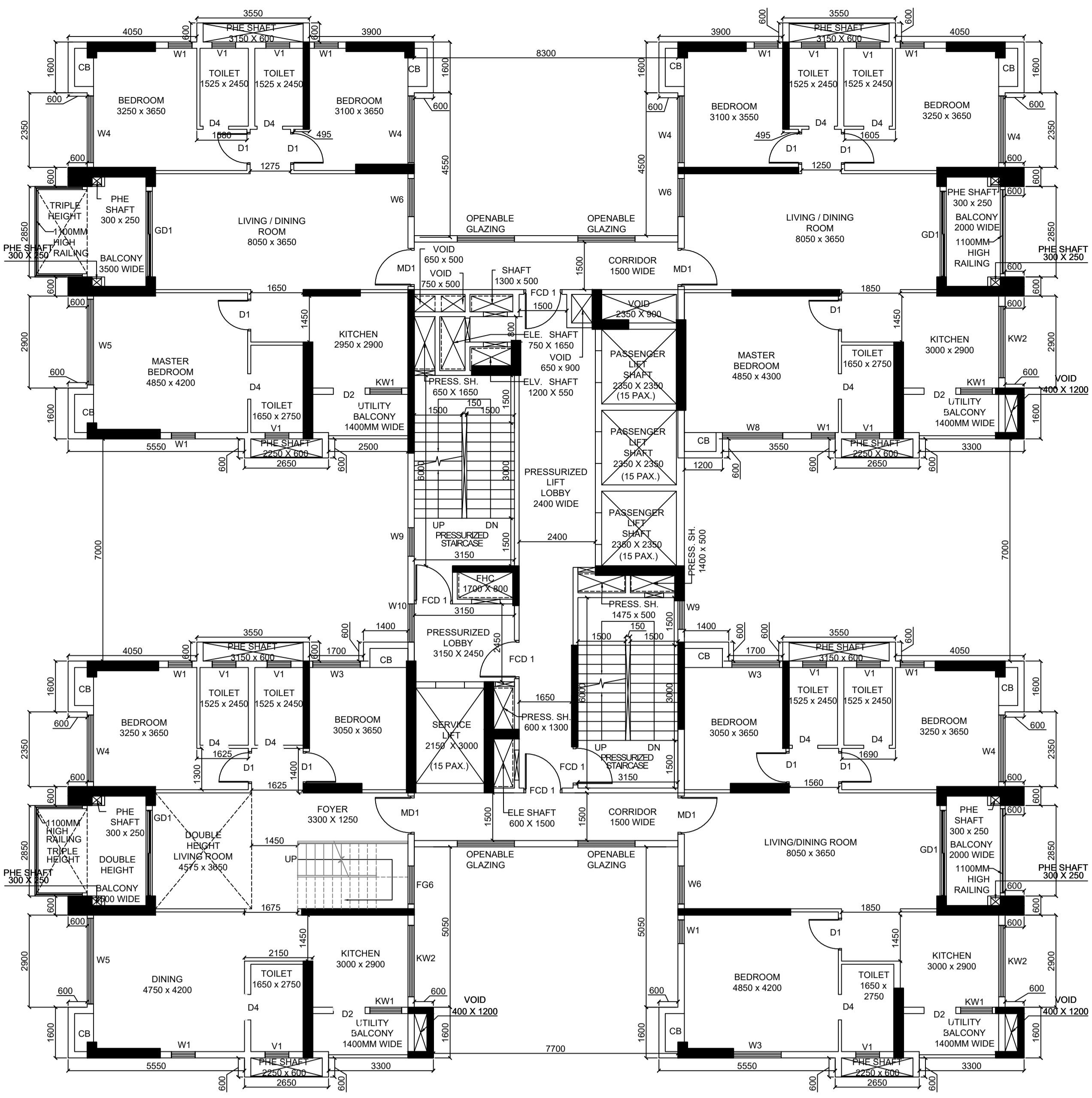

**5TH, 17TH FLOOR PLAN
(LOWER DUPLEX -
TRIPLE HEIGHT BALCONY -
TOWARDS FIRE DRIVEWAY)**

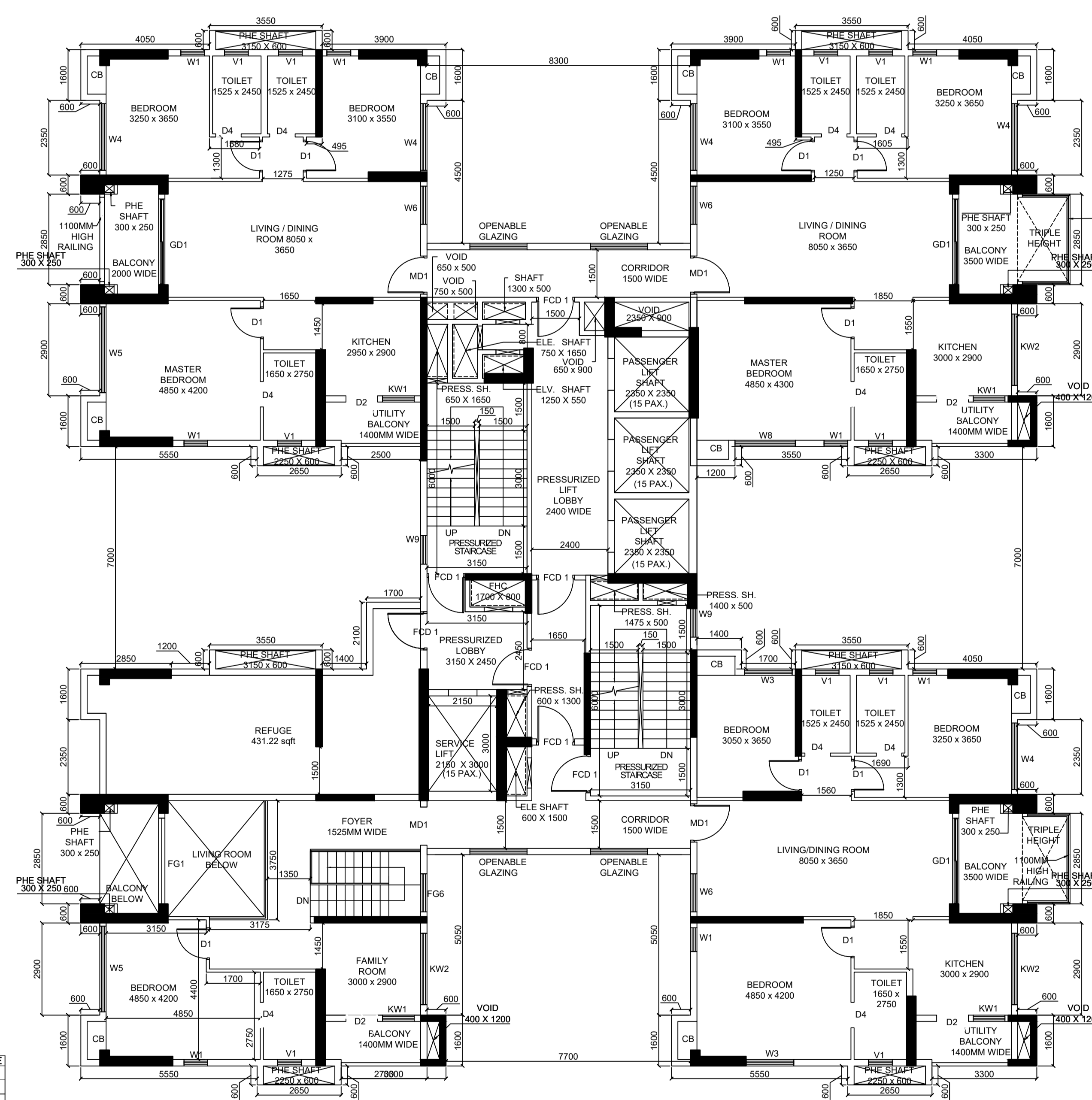

**6TH, 18TH FLOOR PLAN
(REFUGE - UPPER DUPLEX
- TRIPLE HEIGHT BALCONY
- TOWARDS PODIUM)**

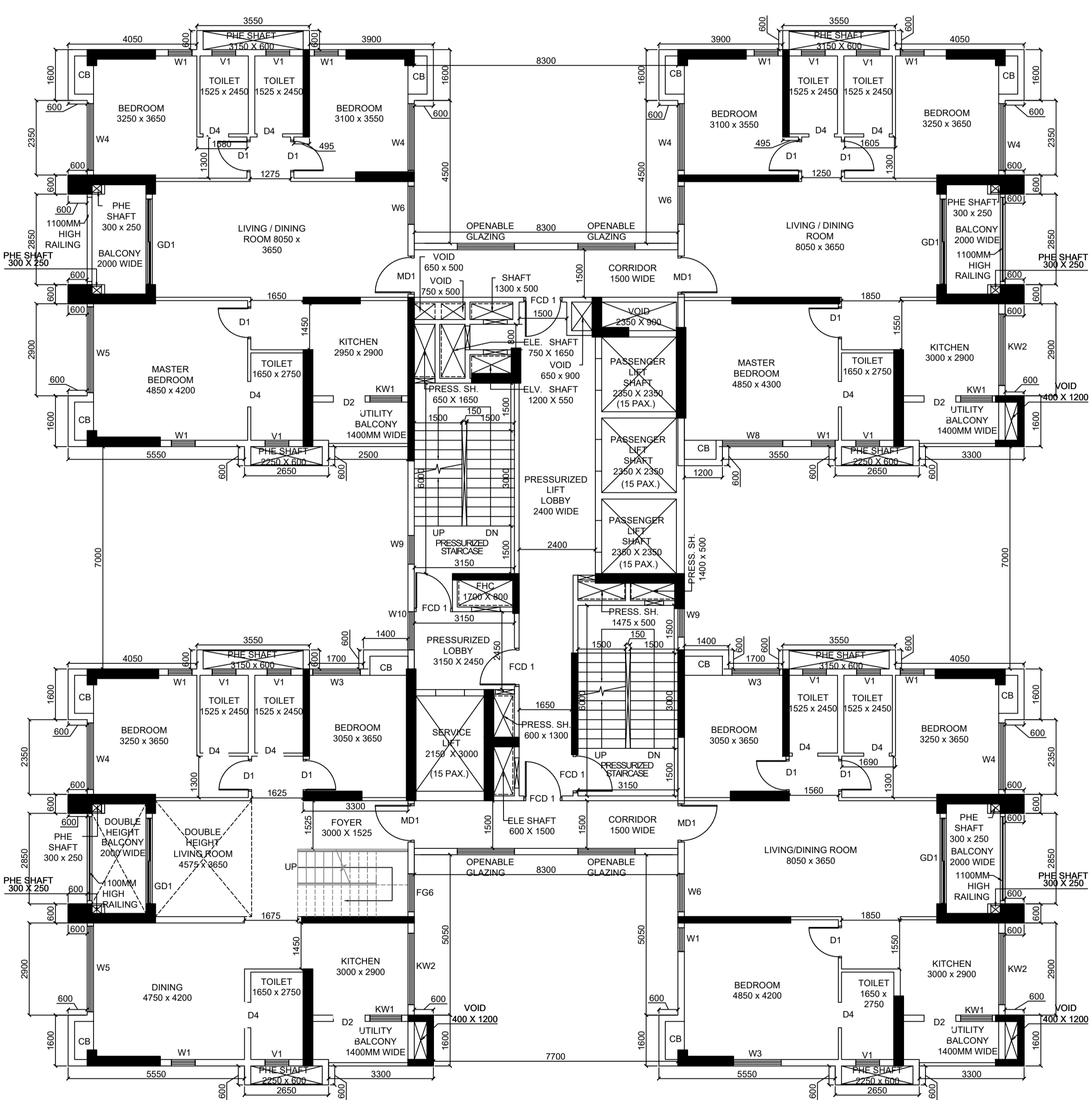

**13TH FLOOR PLAN
(LOWER DUPLEX)**

DOOR WINDOW SCHEDULE

TAG	SIZE
GD1	1200 X 2150
GD2	2000 X 2250
GD3	2400 X 2250
GD4	1500 X 1950
MD1	1200 X 2400
D1	1000 X 2250
D2	1500 X 2400
D3	900 X 2250
D4	800 X 2250
D5	2000 X 2150
D6	1200 X 2250
DD1	1800 X 2400
DD2	1500 X 2400
DD3	2000 X 2400
GD1	2700 X 2400
GD2	3000 X 2400
GD3	2550 X 2400
GD4	2850 X 2400
GD5	2100 X 2400
GD6	3200 X 2400
GD7	3200 X 2400
GD8	2850 X 2400
GD9	2850 X 2400
GD10	2850 X 2400
GD11	2850 X 2400
GD12	2850 X 2400
GD13	2850 X 2400
GD14	2850 X 2400
GD15	2850 X 2400
GD16	2850 X 2400
GD17	2850 X 2400
GD18	2850 X 2400
GD19	2850 X 2400
GD20	2850 X 2400
GD21	2850 X 2400
GD22	2850 X 2400
GD23	2850 X 2400
GD24	2850 X 2400
GD25	2850 X 2400
GD26	2850 X 2400
GD27	2850 X 2400
GD28	2850 X 2400
GD29	2850 X 2400
GD30	2850 X 2400
GD31	2850 X 2400
GD32	2850 X 2400
GD33	2850 X 2400
GD34	2850 X 2400
GD35	2850 X 2400
GD36	2850 X 2400
GD37	2850 X 2400
GD38	2850 X 2400
GD39	2850 X 2400
GD40	2850 X 2400
GD41	2850 X 2400
GD42	2850 X 2400
GD43	2850 X 2400
GD44	2850 X 2400
GD45	2850 X 2400
GD46	2850 X 2400
GD47	2850 X 2400
GD48	2850 X 2400
GD49	2850 X 2400
GD50	2850 X 2400
GD51	2850 X 2400
GD52	2850 X 2400
GD53	2850 X 2400
GD54	2850 X 2400
GD55	2850 X 2400
GD56	2850 X 2400
GD57	2850 X 2400
GD58	2850 X 2400
GD59	2850 X 2400
GD60	2850 X 2400
GD61	2850 X 2400
GD62	2850 X 2400
GD63	2850 X 2400
GD64	2850 X 2400
GD65	2850 X 2400
GD66	2850 X 2400
GD67	2850 X 2400
GD68	2850 X 2400
GD69	2850 X 2400
GD70	2850 X 2400
GD71	2850 X 2400
GD72	2850 X 2400
GD73	2850 X 2400
GD74	2850 X 2400
GD75	2850 X 2400
GD76	2850 X 2400
GD77	2850 X 2400
GD78	2850 X 2400
GD79	2850 X 2400
GD80	2850 X 2400
GD81	2850 X 2400
GD82	2850 X 2400
GD83	2850 X 2400
GD84	2850 X 2400
GD85	2850 X 2400
GD86	2850 X 2400
GD87	2850 X 2400
GD88	2850 X 2400
GD89	2850 X 2400
GD90	2850 X 2400
GD91	2850 X 2400
GD92	2850 X 2400
GD93	2850 X 2400
GD94	2850 X 2400
GD95	2850 X 2400
GD96	2850 X 2400
GD97	2850 X 2400
GD98	2850 X 2400
GD99	2850 X 2400
GD100	2850 X 2400

DECLARATION OF GEO TECHNICAL ENGINEER :
UNDERSIGNED HAS INSPECTED THE SITE AND CARRIED OUT SOIL INVESTIGATION THEREON. IT IS CERTIFIED THAT THE EXISTING SOIL OF THE SITE IS ABLE TO CARRY THE LOAD COMING FROM THE PROPOSED CONSTRUCTION AND THE FOUNDATION SYSTEM PROPOSED HEREIN IS SAFE AND STABLE IN ALL RESPECT FROM GEO TECHNICAL POINT OF VIEW.

SIGNATURE OF GEO TECHNICAL ENGINEER
JISHNU PAL
ENROLLMENT NO. : G.T/11/32

DECLARATION OF STRUCTURAL ENGINEER :
THE STRUCTURAL DESIGN & DRAWING OF BOTH FOUNDATION & SUPERSTRUCTURE OF THE BUILDING HAS BEEN MADE BY ME CONSIDERING ALL POSSIBLE LOADS INCLUDING SEISMIC LOAD AS PER THE NATIONAL BUILDING CODE OF INDIA & CERTIFIED THAT IT IS SAFE & STABLE IN ALL RESPECT. THE RECOMMENDATIONS OF SOIL TEST REPORT HAS BEEN CONSIDERED DURING STRUCTURAL CALCULATION.

SIGNATURE OF STRUCTURAL ENGINEER
ANKIT AGARWALA
ENROLLMENT NO. : ESE/11/72

DECLARATION OF STRUCTURAL REVIEWER OF CERTIFICATE OF OWNER
I HAVE REVIEWED/CHECKED THE STRUCTURAL DRAWING AND DESIGN DETAILS OF THIS PROJECT WHICH HAS BEEN PREPARED BY THE STRUCTURAL ENGINEER ANKIT AGARWALA, HAVING E.S.E. NO. ESE/11/04 WHICH HAS BEEN DONE COMPLYING RELEVANT I.S. CODE INCLUDING SEISMIC AND NATIONAL BUILDING CODE. I CERTIFY THAT THE STRUCTURE WILL BE SAFE AND STABLE AGAINST ALL VERTICAL AND LATERAL LOADS AND WILL BE FIT FOR HABITABLE USE.

SIGNATURE OF STRUCTURAL REVIEWER
UTPAL SANTRA
E.S.R.NO.(STRUCTURAL REVIEWER)- ESR(I)/58/10

CERTIFICATE OF THE ARCHITECT
I HEREBY DECLARE WITH FULL RESPONSIBILITY THAT I SHALL ENGAGE WITH THE ARCHITECT & ESE DURING CONSTRUCTION. I SHALL FOLLOW THE INSTRUCTIONS OF THE ARCHITECT & ESE DURING CONSTRUCTION. KMC AUTHORITY IS NOT LIABLE FOR STRUCTURAL STABILITY OF THE BUILDING AND ADJOINING STRUC. KMC AUTHORITY MAY REVOKE SANCTION PLAN IF ANY DOCUMENT IS FOUND FAKE.

Mr. Indranil Sen
(AUTHORIZED SIGNATORY)
(AMBUJA REALTY DEVELOPMENT LTD.)

CERTIFICATE OF THE ARCHITECT
THIS IS TO CERTIFY THAT THE BUILDING PLAN HAS BEEN DRAWN AS PER THE PROVISIONS OF K.M.C BUILDING RULE 2009 AS AMENDED FROM TIME TO TIME. ABUTTING K.M.C ROAD CONFORMS WITH THE PLAN & THAT IT IS A BUILDABLE SITE.

SIGNATURE OF THE ARCHITECT
NANDA KUMAR V.
CA/2004/34973

PROJECT DETAILS
PROPOSED PLAN FOR B+G+XXVII STORED RESIDENTIAL BUILDING COMPRISING OF SIX TOWERS ALONG WITH ONE No. OF CLUB BUILDING (B+G+2) CONNECTED AT BASEMENT, GROUND & PODIUM LEVEL AND A SINGLE STOREY TEMPLE BLOCK AT - PREMISES NO. 828 CHOWBHAGHA, RS. PLOT NO. J. DAG NO. 651 (PART) KHATIAN NO. 615 IN MOUZA NONVADANGA, J.L NO 10, BOROUGH NO. XII, WARD NO 108, P. S. ANANDAPUR P. O. ANANDAPUR, KOLKATA 700107, COMPLYING KMC BUILDING RULE 2009 (READ WITH RULE 69A(1)(a), 70(5) & 69(2)(g)) US 393A OF KMC ACT, 1980. ASSESSEE NO - 311080310436

PROPOSED 10TH, 22ND FLOOR PLAN
PROPOSED 5TH, 17TH FLOOR PLAN
PROPOSED 6TH, 18TH FLOOR PLAN
PROPOSED 13TH FLOOR PLAN
DRAWING NUMBER: UTPALAA/SANC/ F-31

SCALE: 1:100 **TOWER- 5**

DATE: 22.10.2024

ISSUE STATUS: SANCTION

SIG. OF A.E (C)/BLDG./BOR.-XII/K.M.C.

SIG. OF E.E (C)/BLDG./BOR.-XII/K.M.C. SPACE FOR K.M.C.

BUILDING PERMIT (B.P) NO - 2024120400

DATE OF SANCTION - 15.01.2025

THE SANCTION IS VALID UP TO - 14.01.2030